

Mk III Service Tip: 0625mt Changing to Sealed Beam Lights

Starting with chassis 1663 Superformance changed the headlight system in the Mark III to comply with DOT standards. Prior to this change a reflector lens was used with a halogen bulb, within the lens was the marker light. The marker lights used a single filament bulb that operated the turn signal only.

Superformance will no longer be furnishing these early light assemblies as replacement parts. In the case of an accident that damages one or more of the headlight assemblies, it will necessary to change over all of the old lighting system to the sealed beam system.

There are no issues concerning the continuing use of the early lights or is necessary to change over to sealed beam for any other reason except for damage.

Parts needed:

Two sealed beam headlights H6024 Wagner High/Low Beam Halogen

Two headlight bucket or as many as are damaged, undamaged buckets can be reused.

Two dual filaments marker light assemblies

Optional: headlight harness and plug kit. Needed only if plugs or headlight harness is damaged.

Note: There are two methods of wiring to do this change over. If none of the wiring is damaged and can be reused it is simpler to do the first method listed here. If the wiring to the buckets or the plugs is damaged then the second method is recommended

Replacing Headlights, Reusing Original Wiring

1. Disconnect the battery or turn off kill switch.



Fig. 1

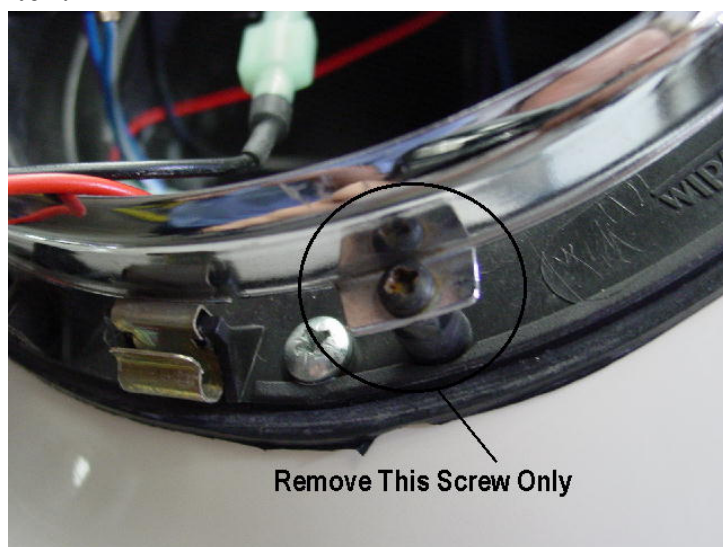

Fig. 2

- Remove the single screw from under the trim ring. Pull the trim ring out from the bottom and then lift up. (Fig. 1)
- On the headlight ring, remove only the screw shown in Fig. 2. The remaining two screws are in slotted holes and are adjusters. The headlight and ring can be maneuvered out of these screws through the slots.

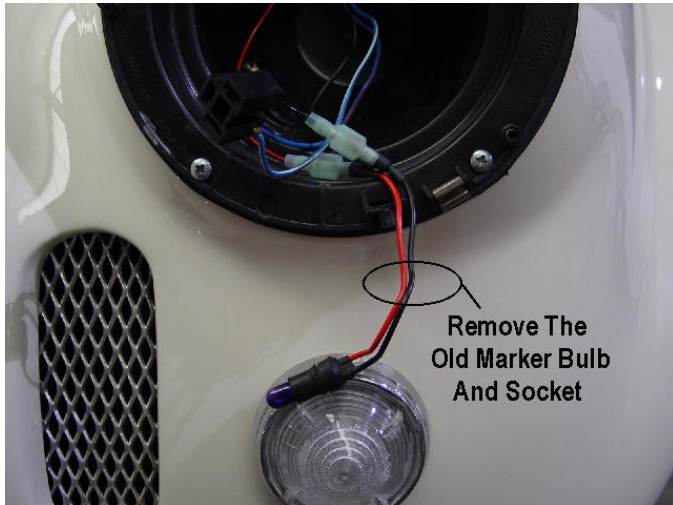

Fig. 3

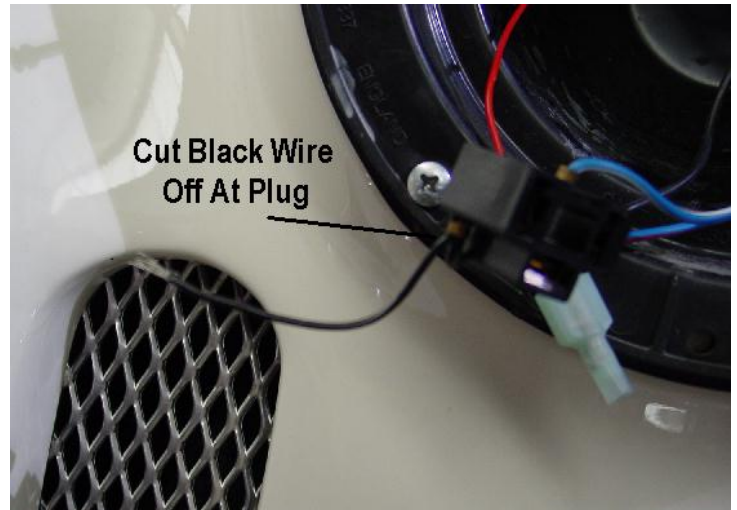

Fig. 4

- Remove the marker light socket shown in Fig. 3.
- Cut the black wire off even with the headlight plug.

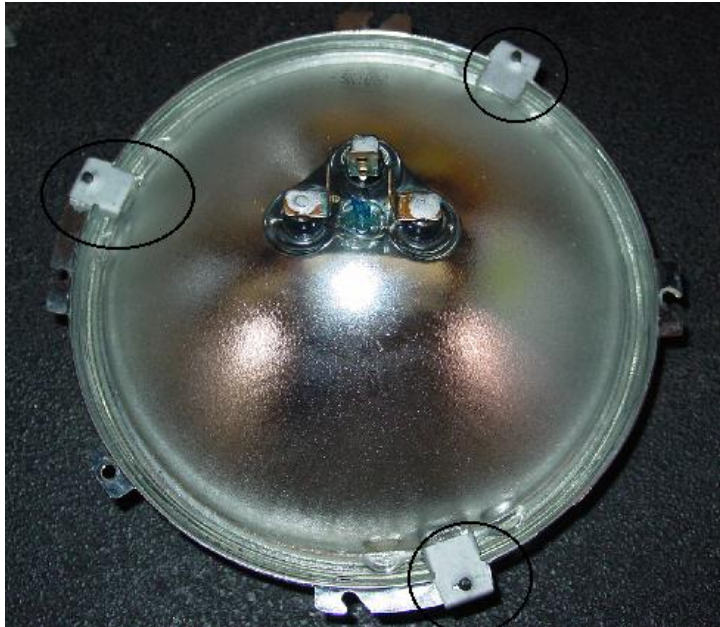

Fig. 5



Fig. 6

- Remove the old headlight reflector lens and replace it with the sealed beam bulb using the three attaching brackets as shown in Fig. 5.
- Install the bulb and ring into the headlight bucket, working it back in place on the two headlight adjusters. The attaching screw location is pointed out in Fig. 6.
- You can reinstall the trim ring, as this part is completed.

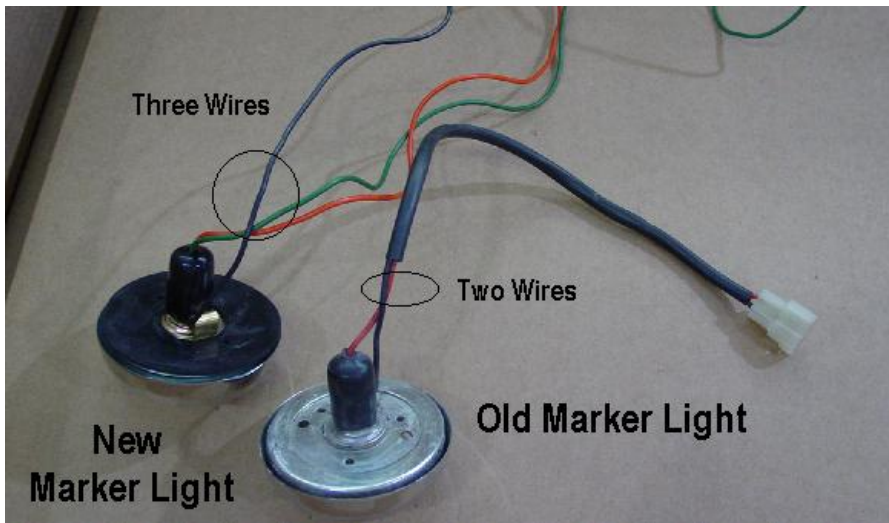

Fig. 7

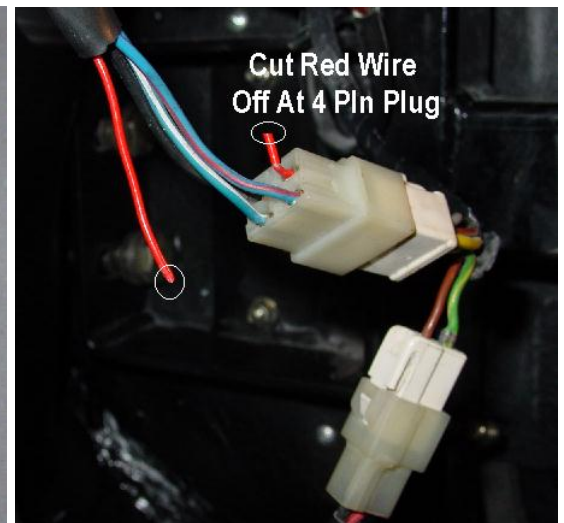

Fig. 8

9. Remove the old marker light assembly Fig. 7. To remove the lens, twist it counter clockwise.
10. The sheathing and plug can be swapped over, using the old light and matching the colors. This will leave you with a green wire left over. Reinstall the new light assembly.
11. Plug the 2-pin plug in. At the 4-pin plug, cut the red wire off about 1/2" from the end of the plug, on the headlight harness side.

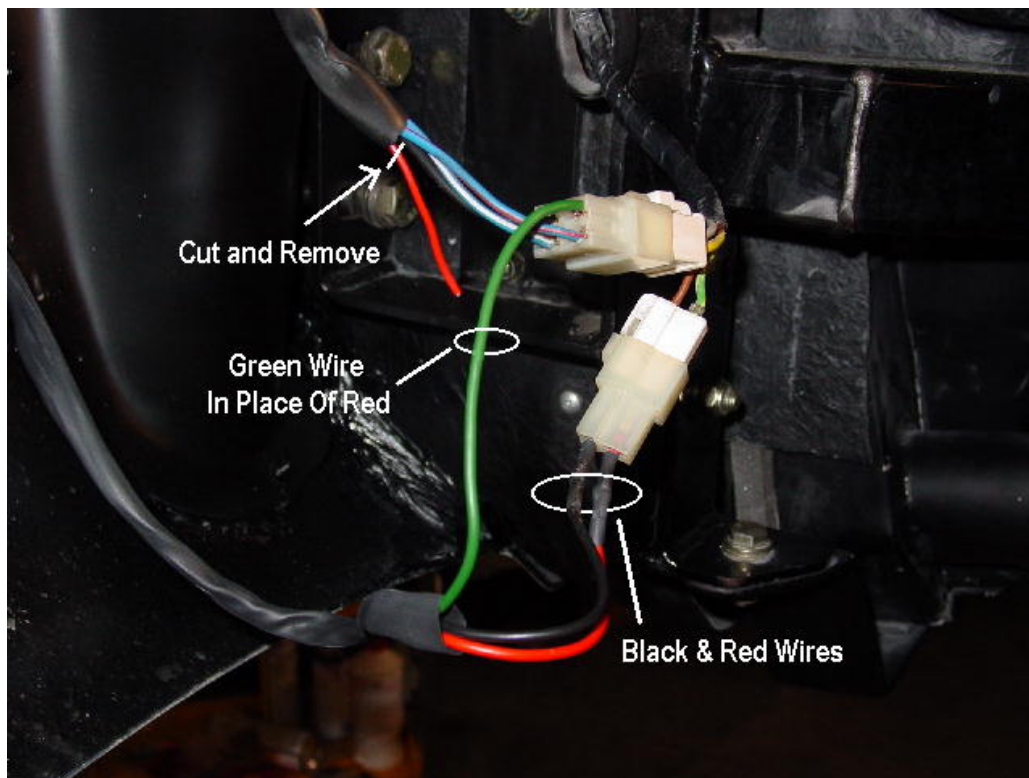
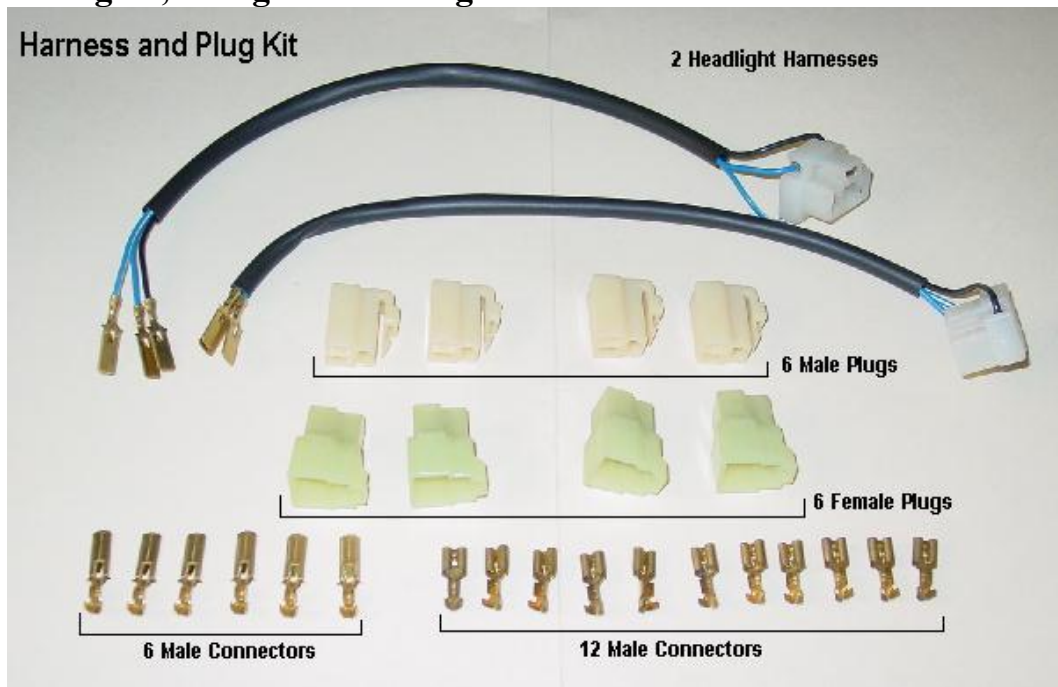

Fig. 9

12. Solder and shrink-wrap the green wire to the red wire at the plug. Fig. 9
13. Reinstall battery cable or turn on kill switch. Check headlight and turn signal operation.

Replacing Headlights, Using New Wiring kit



Before attempting this technique make sure you have all the hardware shown above. If only one side harness is damaged, you need only half of the above-indicated hardware.

1. Disconnect the battery or turn off kill switch
2. Remove the single screw from under the trim ring. Pull the trim ring out from the bottom and then lift up. (Fig. 1 page 1)
3. On the headlight ring, remove only the screw shown in Fig. 2 page 1. The remaining two screws are in slotted holes and are adjusters. The headlight and ring can be maneuvered out of these screws through the slots.

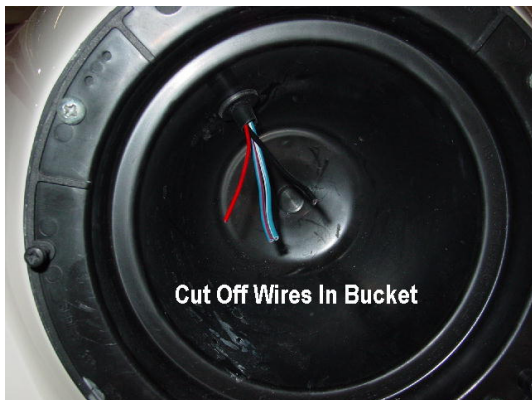

Fig. 10



Fig. 11

4. Cut off the marker light socket and headlight plug as shown in Fig. 10. Unplug the headlight harness and pull the wires through from under the fender. Remove any old sheathing.
5. Cut off the two plugs under the fender as shown in Fig. 11.
6. Insert the new headlight harness through the grommet in the bucket. See Fig. 12

7. Remove the old headlight reflector lens and replace it with the sealed beam bulb using the three attaching brackets as shown in Fig. 5 page 2.
8. Install the bulb and ring into the headlight bucket, working it back in place on the two headlight adjusters. The attaching screw location is pointed out in Fig. 6 page 2. Reinstall the trim ring, as this part is complete.



Fig. 12



Fig. 13

9. Trim the tabs off of the male spades on the headlight harness. Do this to additional males spade that are installed. The spades will not seat if these tabs are not removed. Fig. 13
10. Install three male spades on the wires off the marker light. Install the marker light assembly.

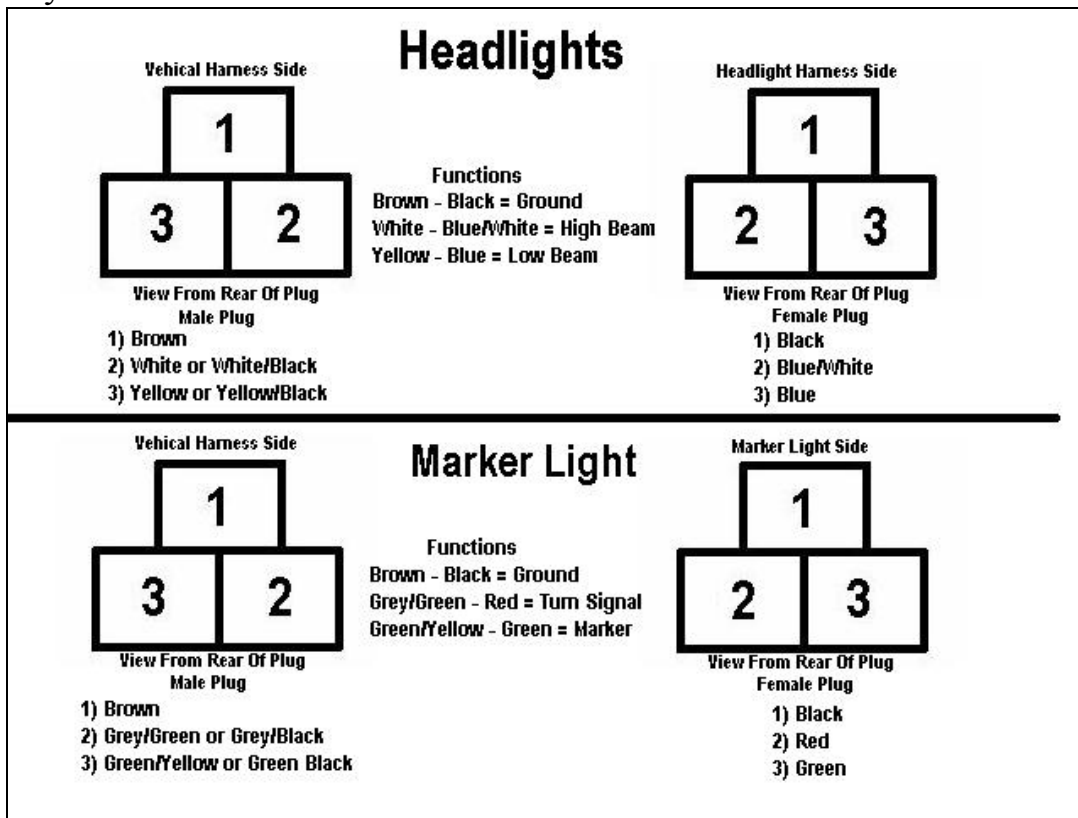

Fig. 14

11. Using the diagram in Fig. 14, install the headlight harness plug and marker light plug. Be sure the spade connectors seat completely in the plugs.

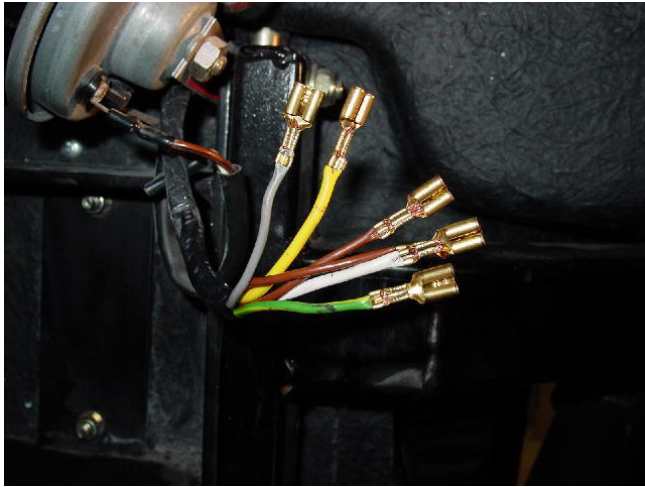

Fig. 15

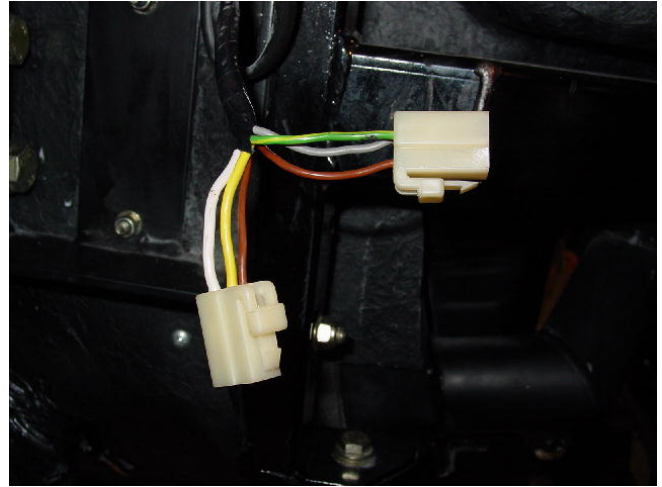

Fig. 16

12. Install 6 female spade connectors onto the chassis harness wiring as shown in Fig. 15.

13. Install 2 female plugs using Fig. 14 as a location guide. Fig. 15

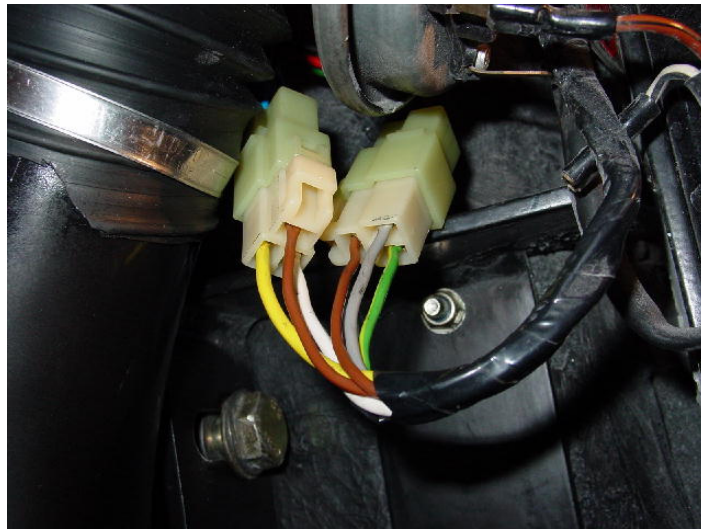

Fig. 17

14. Plug the two plugs into the headlight and marker plugs. Use Fig. 14 as a guide to the plug matching. Fig. 17

15. Zip-tie the harnesses out of the way of the wheel. In Fig. 14 the plug are tucked behind the duct hose for protection.

16. Reinstall battery cable or turn on kill switch. Check headlight and turn signal operation.

Note: Markers with clear lenses must have amber bulbs. Amber lenses must have clear bulbs.

This is a Superformance authorized Service Bulletin.

The modifications or adjustments shown in this service tip have been performed and tested in our service facility. This must be done exactly as stated in these instructions and must be done by a qualified individual. If you have any questions or are not sure of the results please call us and ask.

513-738-4000

We cannot control the results of the shown modification or adjustments and therefore cannot be held liable for the results.

By you doing this modifications or adjustment you solely take full responsibility for the outcome

This Information has been researched and written by Mike Evangelo for use by Superformance Dealers and Owners.

Any unauthorized use of this information is strictly forbidden. Copyright© 2006